

Series 238 PROJECT-OUT MODULAR SIZES

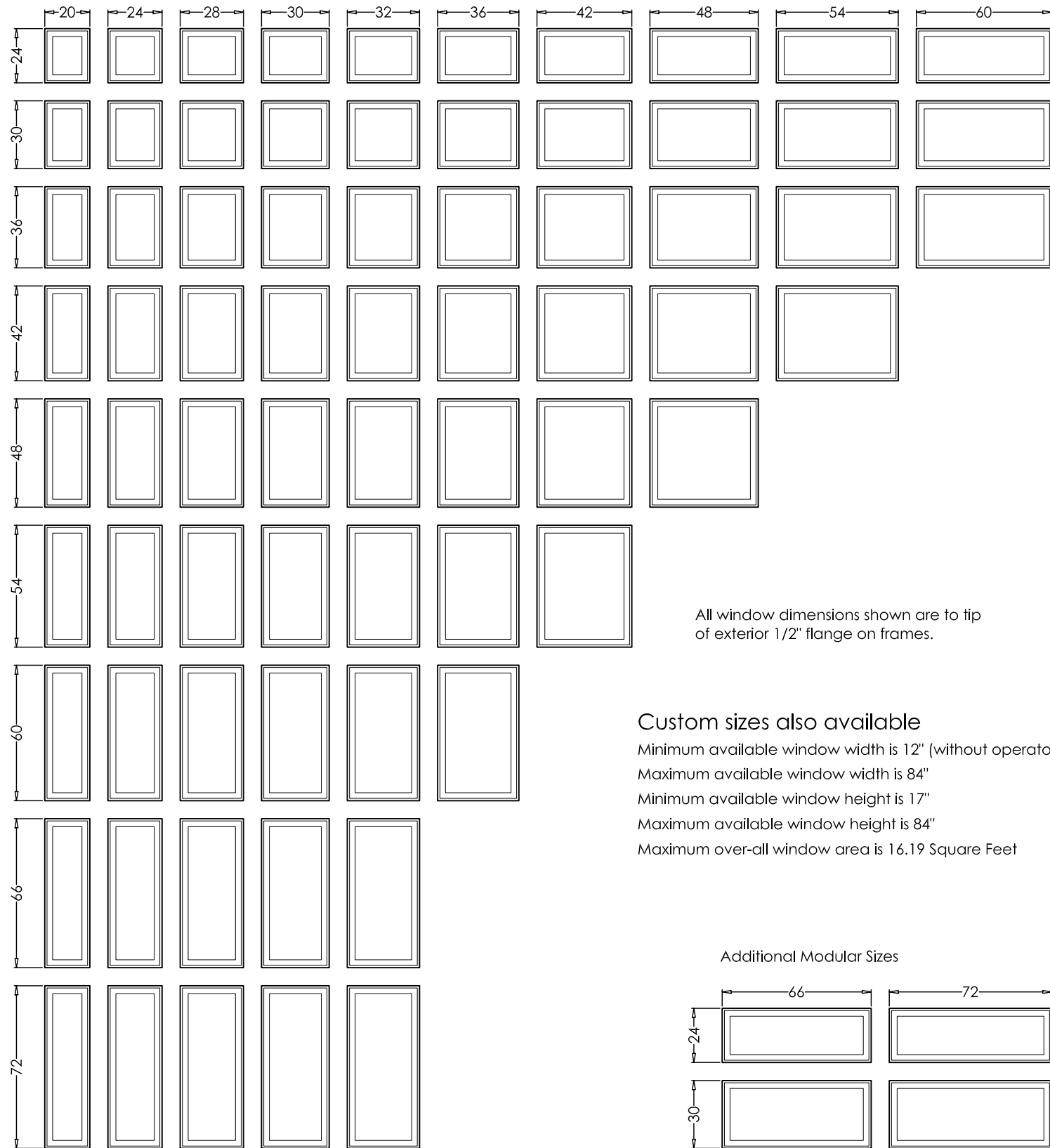

All window dimensions shown are to tip of exterior 1/2" flange on frames.

Custom sizes also available

Minimum available window width is 12" (without operator)
 Maximum available window width is 84"
 Minimum available window height is 17"
 Maximum available window height is 84"
 Maximum over-all window area is 16.19 Square Feet

Additional Modular Sizes

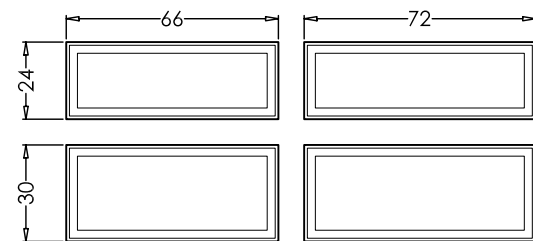

Do not use Project-Out windows where Egress (Emergency Escape) is required

Series 238 PROJECT-OUT COMMODITY SIZES

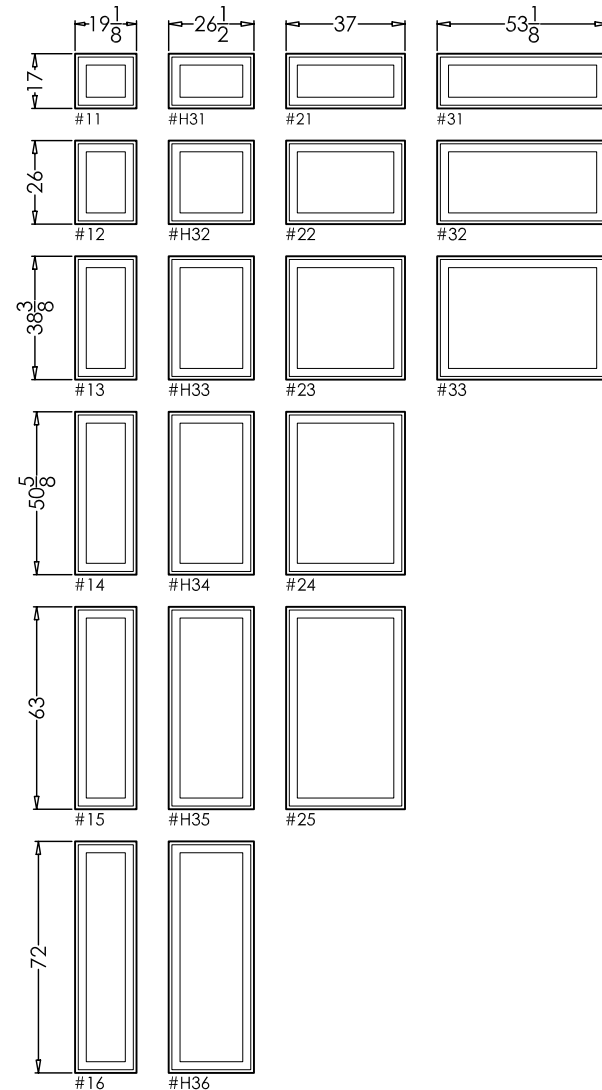

Sample Colonial Configurations

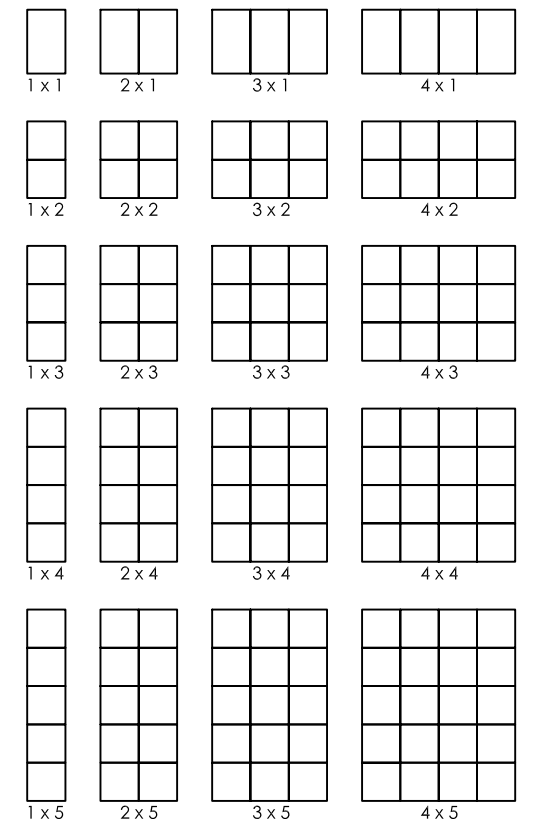

Grid proportions will vary based on window sizes
 Busier grids such as 3 x 6 also available

OPERATOR COMPATABILITY CHART

WINDOW WIDTH	NO OPERATOR	SMALL ARM OPERATOR †	LARGE ARM OPERATOR ‡
under 20" wide	STANDARD	NOT AVAILABLE	NOT AVAILABLE
over 20" up to 31 7/8" wide	AVAILABLE	STANDARD	NOT AVAILABLE
32" up to 84" wide	AVAILABLE	AVAILABLE	STANDARD

† SMALL ARM OPERATORS WILL LIMIT WINDOW OPENING (VENTILATION) TO 2 3/4"

‡ LARGE ARM OPERATORS WILL LIMIT WINDOW OPENING (VENTILATION) TO 8"

MULTI-VENT OPENINGS ARE ACHIEVED BY MULLING (JOINING) WINDOW TOGETHER
 All Series 238 windows can be combined

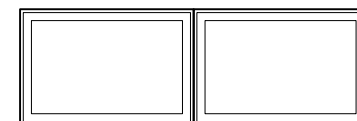

Example of two 54" x 36" windows

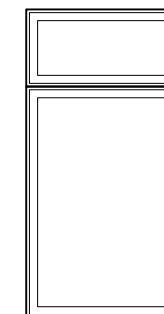

Example of one 48" x 24" Project-Out window above one 48" x 72" Fixed window



Example of two 60" x 24" Project-Out window below one 120" x 54" Fixed window